

RUGER SR-556FB 5.56X45MM NATO-223 REM., \$1995

GUN TESTS GRADE: A-

Tough call between this and the Stag, which we eventually made on price. We didn't shoot enough to decide if the gas-piston system delivered more reliable operation than the proven impingement design, so we decided on what we saw. This gun shot on par with the Stag, and its sights were much better than both the DIG guns, our testers said. The SR's trigger was heavier, though. We liked the Ruger's rail system and pistol grip better than the others.



SPECIFICATIONS

OVERALL LENGTH, MIN/MAX..... 32.75 IN./36 IN.
 BARREL LENGTH..... 16.12 IN. CHROME LINED M-4/1:9 RH
 BARREL LENGTH W/FLASH HIDER..... 17.6 IN.
 FLASH HIDER..... AC-556
 SIGHT RADIUS (MAX.)..... 17.0 IN.
 SIGHTS (F/R)..... TROY FOLDING BATTLESIGHTS,
HK-STYLE FRONT, 2-APERTURE REAR

OVERALL HEIGHT W/O MAG..... 7.5 IN. (SIGHTS DOWN)
 OVERALL HEIGHT W/30-RD. MAG..... 10.4 IN. (SIGHTS UP)
 LOP, MIN..... 10.2 IN.
 LOP, MAX..... 13.5 IN.
 WEIGHT UNLOADED..... 8.4 LBS.
 WEIGHT LOADED W/30-RD. MAG..... 9.4 LBS.
 ACTION (UPPER)..... MIL-SPEC HARD-COAT ANOD. ALUM.
 ACTION TYPE..... TWO-STAGE PISTON-DRIVEN;
CHROME-LINED GAS BLOCK, 4-POS.REGULATOR

MAGAZINES..... 3 30-RD. MAGPUL PMAGS
 BUTTSTOCK..... 6-POS. COLLAPSIBLE,
MIL-SPEC BUFFER & SPRING
 FOREND..... TROY QUAD RAIL
 PISTOL GRIP..... HOGUE MONOGRIP RUBBER
 TRIGGER PULL WEIGHT..... 9.4 LBS., SINGLE STAGE
 WARRANTY..... NONE WRITTEN
 TELEPHONE..... (603) 865-2442
 WEBSITE..... WWW.RUGER.COM/SR556

Top: In the gas-piston system like that used in the Ruger, gases from the barrel vent into the gas block and then against a piston, top, which in turn strikes an operating rod that replaces the gas tube.

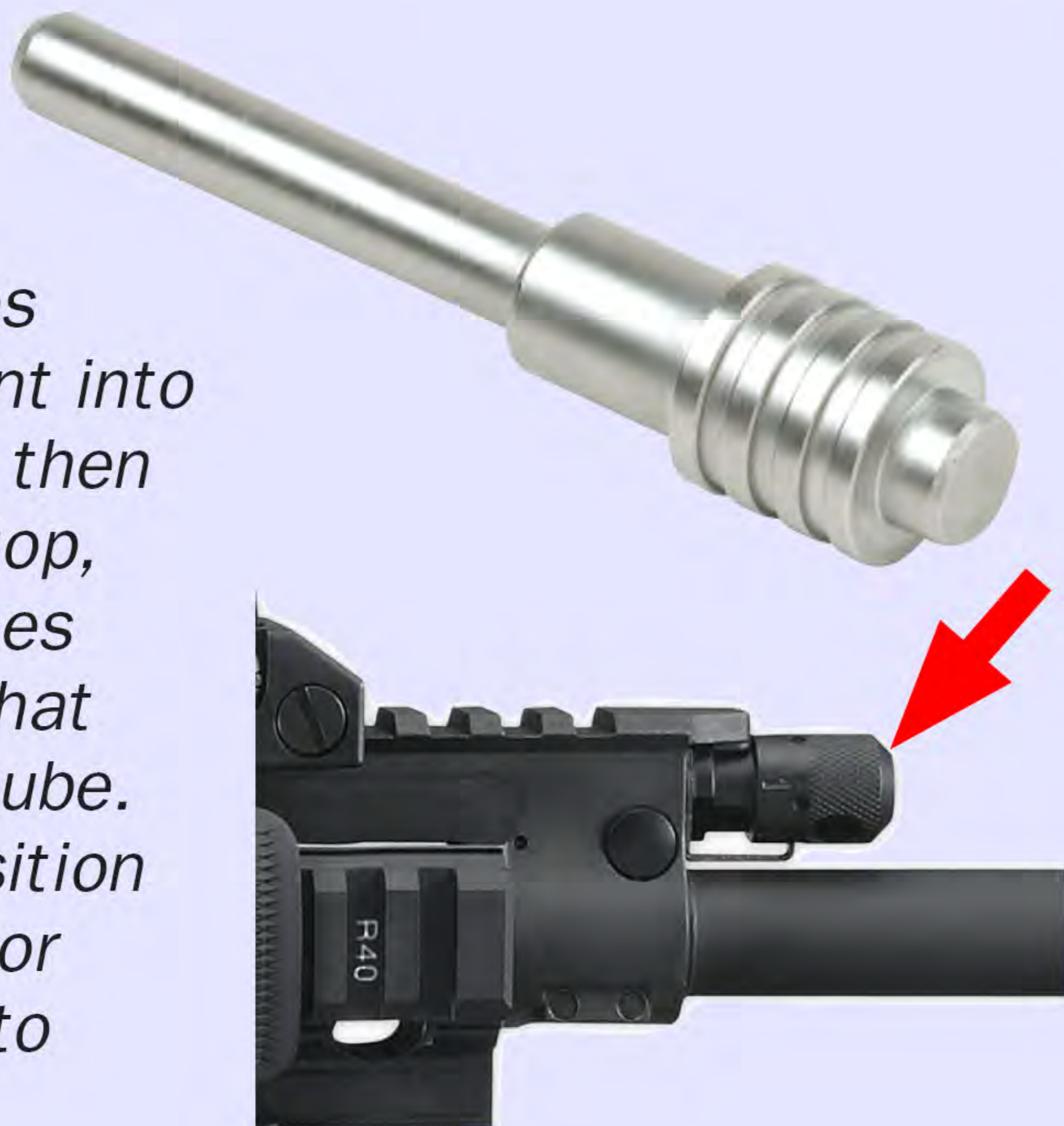

Bottom: The 4-position adjustable regulator can tune the rifle to ammunition.

Right: The SR-556FB is equipped with Troy Industries Folding BattleSights (thus the FB in the name), which our test team praised. Pushing in a spring-loaded button (arrow) allows them to be folded down or flipped up. The windage-adjustable rear sight includes 2 apertures, and the protected HK-style front sight is elevation adjustable.



Left: The Ruger's Troy quad-rail gave the SR-556 plenty of room for flashlights, lasers, bayonets—whatever strikes the shooter's fancy. We counted 50 inches of mounting surface on the sides and top of the gun. **Right:** We also liked the supplied Troy rail covers. The panels slipped on and off the rails easily when the tab at right (arrow) was lifted slightly. The Stag was supposed to come with covers, but didn't. We'd buy the Troy covers as replacements.

